

# SCREWED BRASSWARE

## TEE FI

### Product Specifications

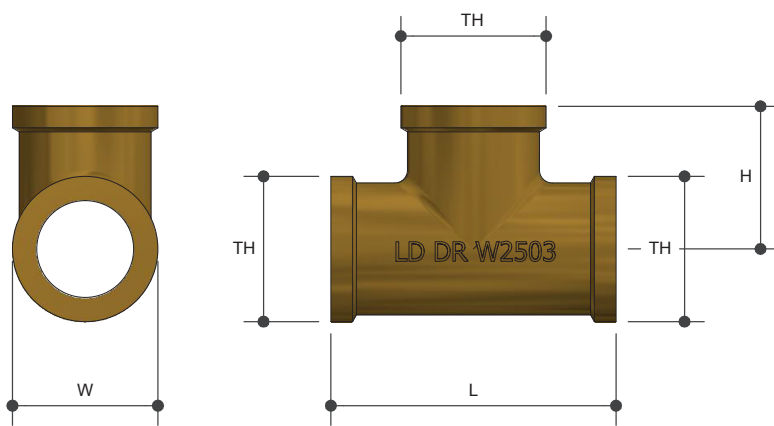

### Specifications

Working temperature 1 °C to 60 °C

Max. pressure rating 1600kPa

### Sizing Chart (MM)

	L	H	W	TH
AW401	26	13	15	Rp 1/8"
AW402	38	19	18	Rp 1/4"
AW403	45	22	23	Rp 3/8"
AW404	50	25	26	Rp 1/2"
AW404NB	50	25	26	Rp 1/2"
AW405*	50	25	28	Rp 1/2"
AW406	60	30	34	Rp 3/4"
AW406NB	60	30	34	Rp 3/4"
AW408	68	34	40	Rp 1"
AW408NB	68	34	40	Rp 1"
AW410	87	44	49	Rp 1 1/4"
AW410NB	87	44	49	Rp 1 1/4"
AW411	89	45	56	Rp 1 1/2"
AW412	112	56	70	Rp 2"
AW413	140	70	87	Rp 2 1/2"

\* Chrome Plated

### Features

Watermark approved

Brass and chrome finish

Tested and certified to AS 3688

### Material Chart

Part	Material
Tee	DR Brass

For more information on Metforge, contact:

Austworld 15 Activity Crescent, Molendinar, Queensland 4214 Australia

P. 1300 780 430

F. 1300 780 441

E. info@austworld.com.au

Austworld Pty Ltd. All rights reserved 2018. Austworld and Metforge are registered trade mark belonging to Austworld Pty Ltd.

