

NON RETURN VALVE

Foot Valve

Product Specifications

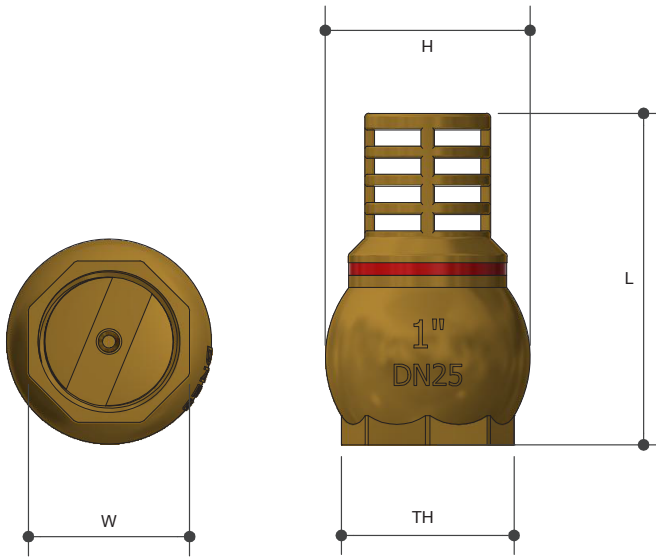

Specifications

Working temperature 1 °C to 120 °C

Maximum pressure rating 1600kPa

Features

Available in sizes 15mm (1/2") to 100mm (4")

Wide body for excellent flow

Sizing Chart (MM)

	L	H	W	TH
FT15	60	30	26	G 1/2"
FT20	76	42	31	G 3/4"
FT25	77	44	38	G 1"
FT32	97	57	46	G 1 1/4"
FT40	107	63	53	G 1 1/2"
FT50	120	77	66	G 2"
FT65	138	89	82	G 2 1/2"
FT80	145	111	95	G 3"
FT100	184	139	121	G 4"

Material Chart

Part	Material
Washer	Fibre
Cap	Brass
Body	Brass

For more information on Logi Valve, contact:
Austworld 15 Activity Crescent, Molendinar, Queensland 4214 Australia
P. 1300 780 430 F. 1300 780 441 E. info@austworld.com.au

Austworld Pty Ltd. All rights reserved 2018. Austworld and Logi Valve are registered trade mark belonging to Austworld Pty Ltd.

